

ALL DIMENSIONS ARE IN mm UNLESS NOTED OTHERWISE

N.G.R | E: 374586 N: 163770

DIRECTIONS:
 MERGE ONTO M6, AT JUNCTION 11A, USE THE LEFT 2 LANES TO TAKE THE M6 EXIT TO BIKDINGHAM/M5, KEKD RIGHT TO CONTINUE ON M6, FOLLOW SIGNS FOR BIKDINGHAM S/M5 SW
 KEKD RIGHT TO STAY ON M6, AT JUNCTION 8, TAKE THE M5 EXIT TO BIKDINGHAM(WEST)/BIKDINGHAM(SOUTH)/WEST BROMWICH, CONTINUE ONTO M5, AT JUNCTION 15, USE THE LEFT 2 LANES TO TAKE THE M4(E) EXIT TO LONDON/BRISTOL(C)/M32, MERGE ONTO M4, AT JUNCTION 18, TAKE THE A46 EXIT TO BATH/STROUD, TOKDARTON INTERCHANGE, TAKE THE 3RD EXIT ONTO A46
 CONTINUE STRAIGHT TO STAY ON A46, CONTINUE STRAIGHT TO STAY ON A46, CONTINUE STRAIGHT TO STAY ON A46, USE THE LEFT LANE TO TAKE THE A4 SLIP ROAD TO BATH/WAKDINSTER/A36
 AT LONDON RD JCT, TAKE THE 3RD EXIT ONTO LONDON RD W/A4, TURN LEFT ONTO CLEVELAND PL, CONTINUE ONTO BATHWICK ST, CONTINUE ONTO SYDNEY PL/A36, GO THROUGH 1 ROUNDABOUT, AT CHURCHILL BRIDGE ROUNDABOUT, TAKE THE 1ST EXIT ONTO WELLS RD/A367, CONTINUE TO FOLLOW A367, TURN RIGHT ONTO BLOOMFIELD RD

NOTES:

A	Issued for Approval	KD	NB	31.01.24
REV	MODIFICATION	BY	CH	DATE



Unit E, Madison Place, Northampton Road,
 Manchester, M8B 5AG
 Tel: 0161 785 4500
 Fax: 0161 785 4501
 Web: www.clarke-telecom.com



Cell Name		Opt.
BLOOMFIELD ROAD		A
Cell ID No		
CORNERSTONE	VMO2	VF
13242601	NA	77719

Site Address / Contact Details

BLOOMFIELD ROAD
 BATH
 BA2 4RT

Drawing Title:		SITE LOCATION MAPS	
Purpose of issue:		PLANNING	Dwg Rev:
Drawing Number:		100	A
Surveyed By:	SS	Original Sheet Size:	A3
Drawn:	KD	Date:	31.01.24
Checked:	NB	Date:	31.01.24
Pack Issue:		B	

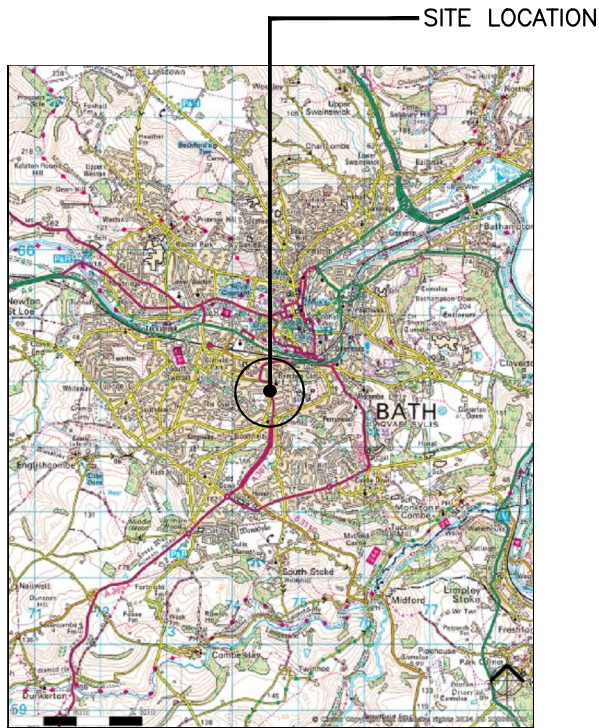
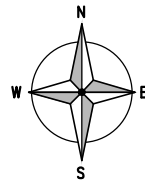

0 500 1000 1500 2000 2500m
 1:50000

SITE LOCATION
 (Scale 1:50000)
 Ordnance Survey map extract based upon Landranger map series with the permission of the controller of Her Majesty's Stationery Office Licence No. 0100035093 Crown copyright.



SITE PHOTOGRAPH

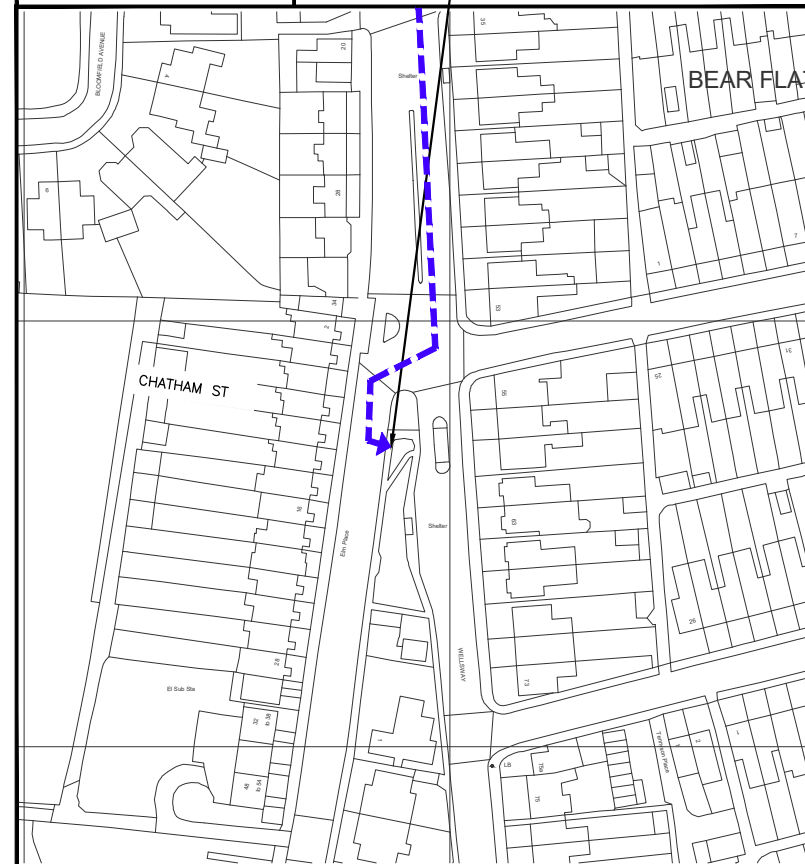
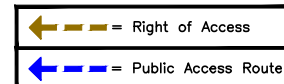

1638 00

1637 00

3745 00

3746 00

DETAILED SITE LOCATION

(Scale 1:1250)
 Based upon Ordnance Survey map extract with the permission of the Controller of Her Majesty's Stationery Office. Crown copyright. Licence No. 100035093

0 12.5 25 37.5 50 62.5m
 1:1250

These drawings comply with VF Standard ICNIRP Guidelines under configuration VM7F Designed in accordance with Cornerstone Document : SDN009 "ICNIRP Compliance Summary (v6)"

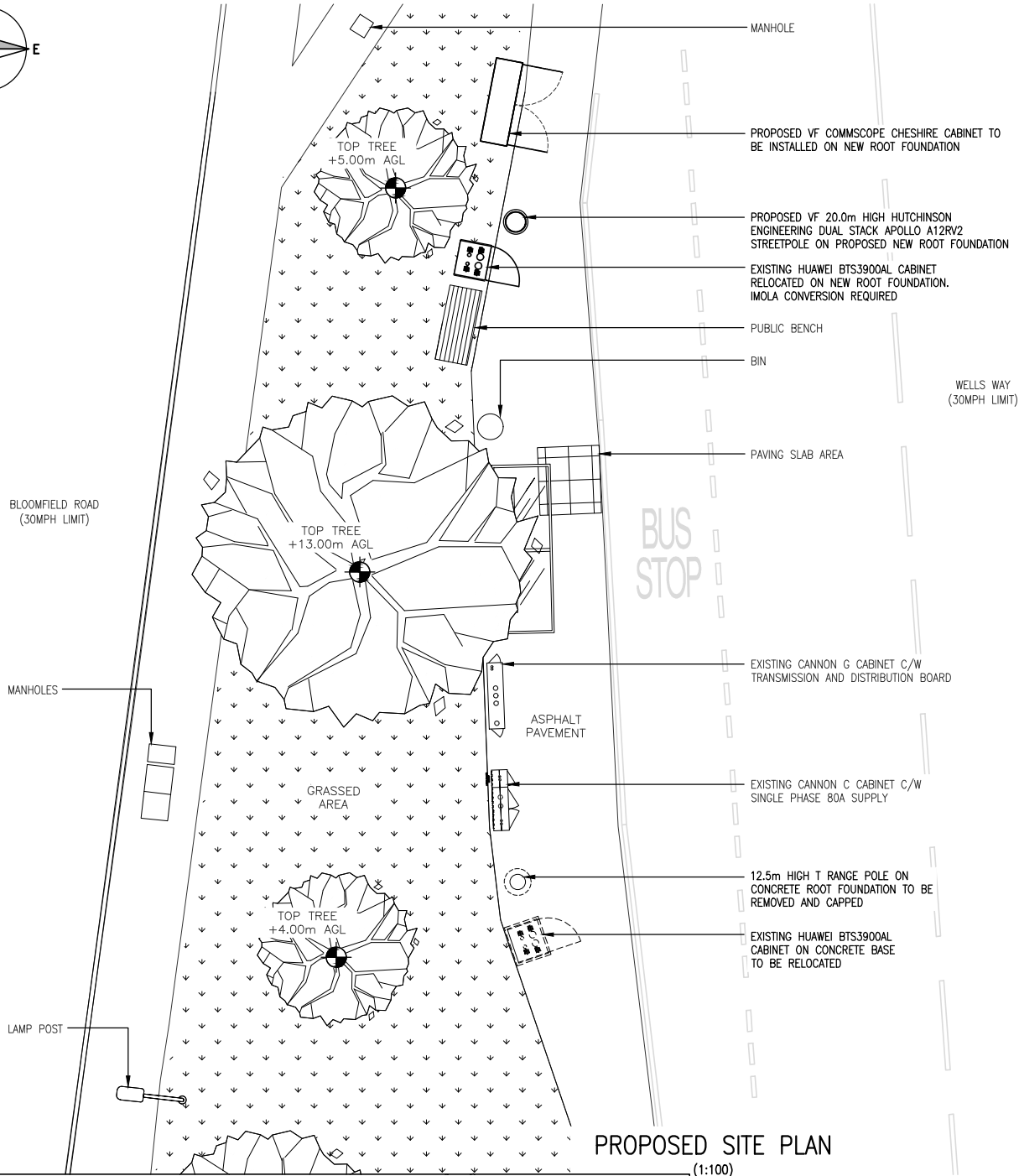
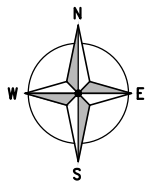

PROPOSED SITE PLAN
(1:100)

These drawings comply with VF Standard ICNIRP Guidelines under configuration VM7F Designed in accordance with Cornerstone Document : SDN009 "ICNIRP Compliance Summary (v6)"

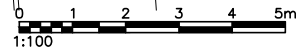

ALL DIMENSIONS ARE IN mm UNLESS NOTED OTHERWISE

N.G.R | E: 374586 N: 163770

NOTES:

NOTE: AS PART OF PROPOSED POLE INSTALLATION SERVICE DIVERSION HAS BEEN APPROVED BY CLIENT

REV	MODIFICATION	BY	CH	DATE
A	Issued for Approval	KD	NB	31.01.24

Cell Name		Opt.
BLOOMFIELD ROAD		A
Cell ID No		
CORNERSTONE	VMO2	VF
13242601	NA	77719

Site Address / Contact Details
BLOOMFIELD ROAD
BATH
BA2 4RT

Drawing Title: PROPOSED SITE PLAN		Dwg Rev:
Purpose of issue: PLANNING		
Drawing Number: 201		A
Surveyed By: SS	Original Sheet Size: A3	Pack Issue:
Drawn: KD	Date: 31.01.24	Checked: NB
	Date: 31.01.24	Date: 31.01.24
		B

ALL DIMENSIONS ARE IN mm UNLESS NOTED OTHERWISE

N.G.R | E: 374586 N: 163770

NOTES:

A	Issued for Approval	KD	NB	31.01.24
REV	MODIFICATION	BY	CH	DATE



Unit E, Madison Place, Northampton Road,
Manchester, M40 5AG
Tel: 0161 785 4500
Fax: 0161 785 4501
Web: www.clarke-telecom.com



Cell Name		Opt.
BLOOMFIELD ROAD		A
Cell ID No		
CORNERSTONE	VMO2	VF
13242601	NA	77719

Site Address / Contact Details

BLOOMFIELD ROAD
BATH
BA2 4RT

Drawing Title:		EXISTING SITE ELEVATION	
Purpose of issue:		PLANNING	Dwg Rev:
Drawing Number:		300	A
Surveyed By:	SS	Original Sheet Size:	A3
Drawn:	KD	Date:	31.01.24
Checked:	NB	Date:	31.01.24
Pack Issue:		B	

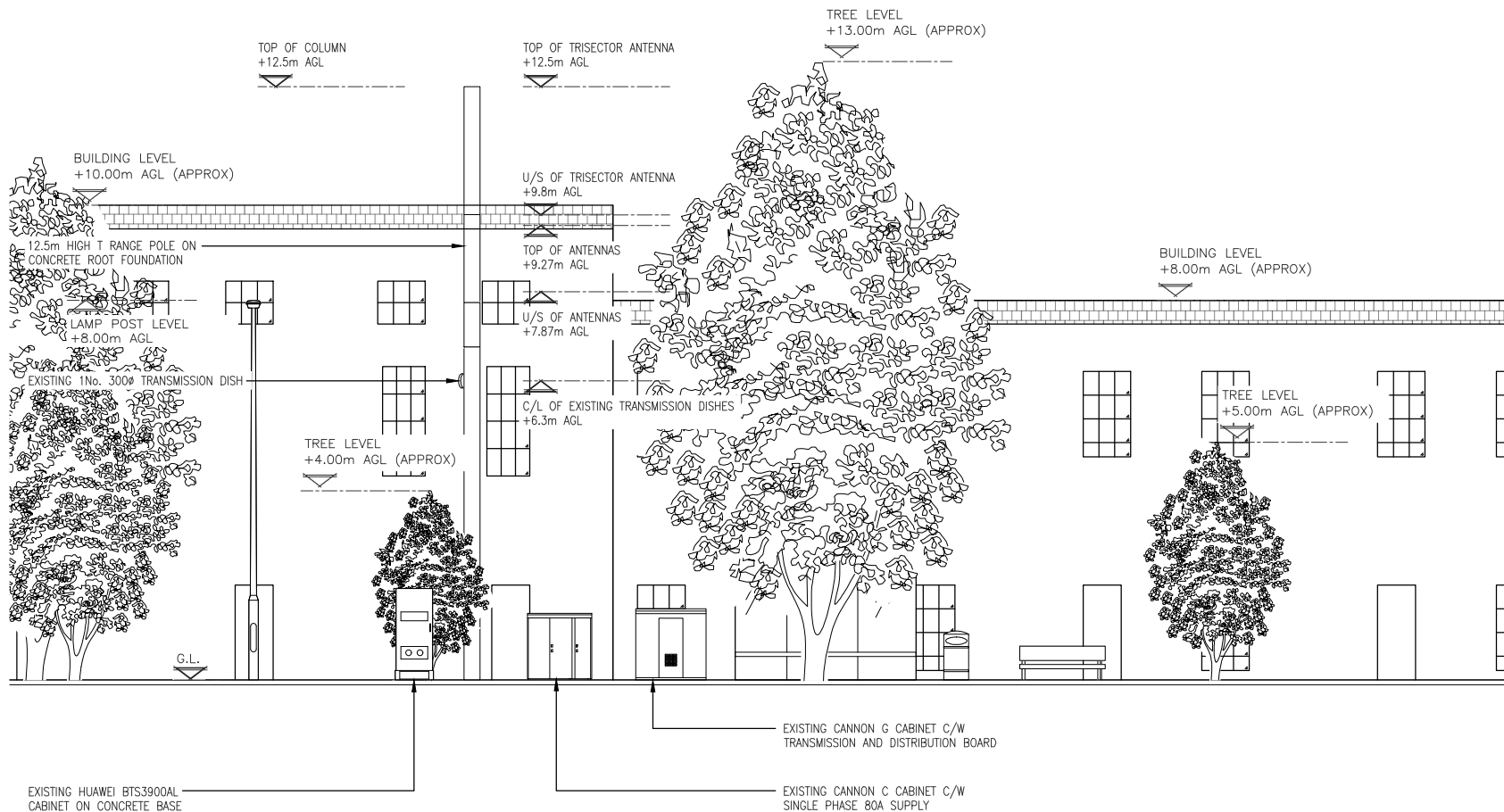

EXISTING EAST ELEVATION
(1:100)

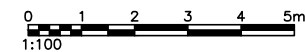

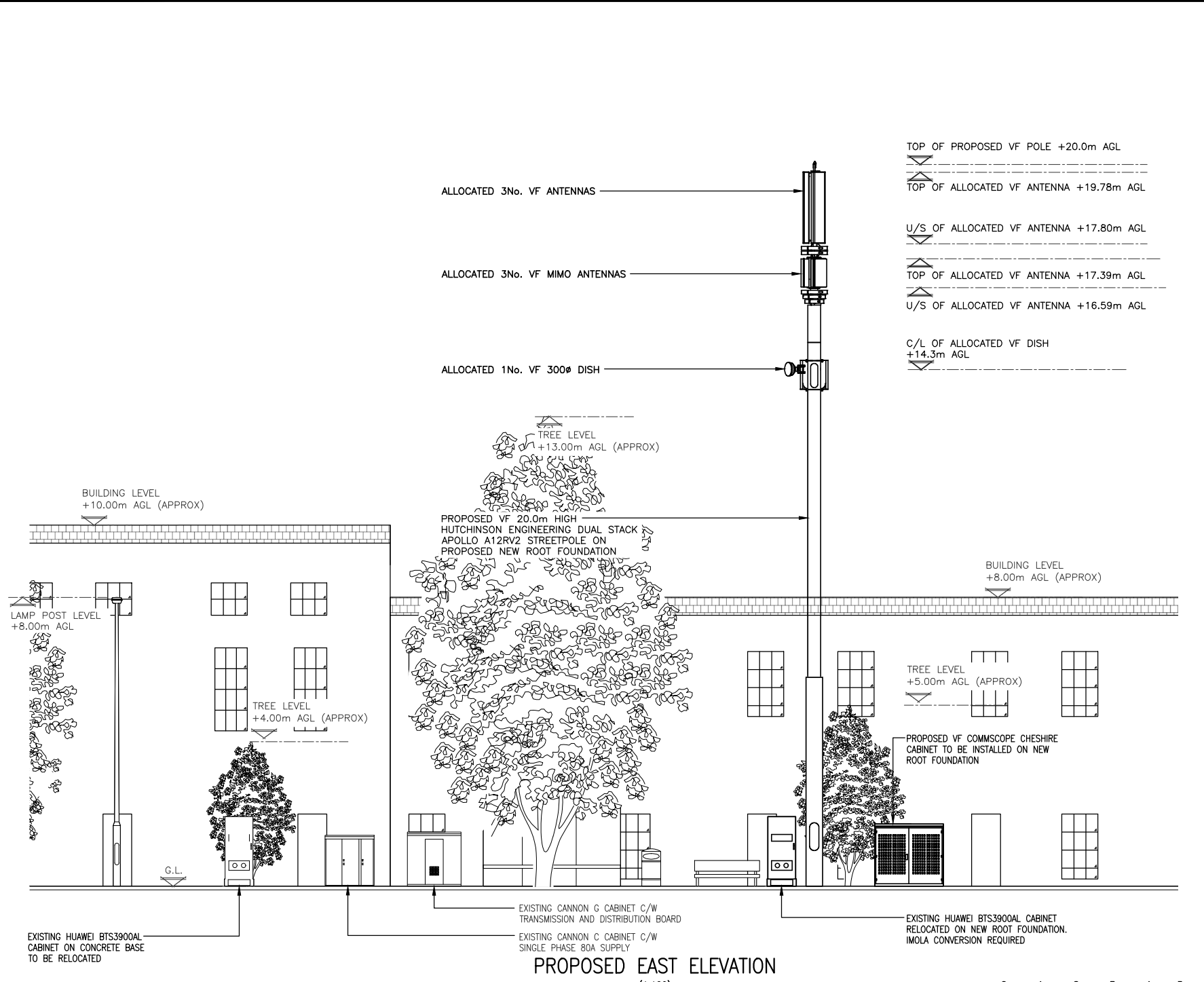

PROPOSED EAST ELEVATION

(1:100)

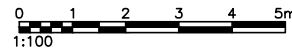

These drawings comply with VF Standard ICNIRP Guidelines under configuration VM7F Designed in accordance with Cornerstone Document : SDN0009 "ICNIRP Compliance Summary (v6)"

ALL DIMENSIONS ARE IN mm UNLESS NOTED OTHERWISE

N.G.R E: 374586 N: 163770

NOTES:

A	Issued for Approval	KD	NB	31.01.24
REV	MODIFICATION	BY	CH	DATE

Cell Name: BLOOMFIELD ROAD Opt: A

Cell ID No

CORNERSTONE	VMO2	VF
13242601	NA	77719

Site Address / Contact Details

BLOOMFIELD ROAD
BATH
BA2 4RT

Drawing Title: PROPOSED SITE ELEVATION

Purpose of issue: PLANNING Dwg Rev:

Drawing Number: 301 A

Surveyed By: SS Original Sheet Size: A3 Pack Issue:

Drawn: KD Date: 31.01.24 Checked: NB Date: 31.01.24 B